

What to see and do

Don't miss these seasonal attractions—they are included with your admission: Butterflies & Blooms, Model Railroad Garden, and the Grand Tram Tour, weather permitting



DINE Take in a spectacular view at the Garden View Café, which features local, sustainably produced, seasonal offerings. A kids' menu is available, and there are vegetarian and gluten-free options. We also offer breakfast, lunch, grab-and-go food and drink, a barista station for specialty coffeehouse options, pastries, and desserts. Open daily.

The outdoor Garden Grille offers grass-fed beef burgers, chicken sandwiches, bratwurst, and jumbo hot dogs; open daily, May through October. Our Rose Terrace Beer Garden offers paninis and flatbreads, along with a variety of local microbrews and wine; open daily, May through October (weather permitting).

The Garden Vine at the Regenstein Fruit & Vegetable Garden serves freshly prepared juices, patisserie-style sweets, wine by the glass, and an array of freshly prepared small bites and snacks. Open weekends, Memorial Day through Labor Day. chicagobotanic.org/café

SHOP The Garden Shop is the place to find inspiration for your garden and home. Garden members receive 10 percent off regularly priced items. All proceeds benefit the Garden. chicagobotanic.org/visit/shop

FAMILY FUN In addition to seasonal attractions, families can get inspired by the natural world at the Regenstein Learning Campus and its Nature Play Garden, Grunsfeld Children's Growing Garden, and Kleinman Family Cove. Pick up a bingo card at the Visitor Center too.

chicagobotanic.org



chicago botanic garden

Interested in more connections with nature?

Our partners, the Forest Preserves of Cook County, offer guided nature hikes, free Camping 101 workshops, family fishing events, and more on nearly 70,000 acres of land. The Chicago Botanic Garden is grateful for and proud of our longstanding partnership with the Forest Preserves, one of the oldest and largest forest preserve districts in the United States. The Forest Preserves owns the 385 acres on which the Garden sits and provides critical operating support.

Learn more at fpdcc.com

Cap Sauers Holding Nature Preserve



A Garden membership pays for itself in as little as two visits! Members receive free admission and free parking every day, plus other benefits. Sign up at chicagobotanic.org/member, or at the Welcome Plaza or Visitor Center Membership desk. If you sign up for a membership on-site, your admission and parking fee for that day will be refunded.

Join the Conversation



FOREST PRESERVES of Cook County

General Information

ACCESSIBILITY Complimentary wheelchairs are available at the Membership & Information Desks in the Visitor Center and at Guest Services on the Welcome Plaza. Accessible parking is located in parking lots 1 and 2. Nearly all areas of the Garden are accessible by wheelchair, as is the Grand Tram Tour. Service animals are permitted on Garden grounds.

ADMISSION Admission is per person; buy your admission tickets in advance to get the best pricing and to ensure your preferred date and time. Daily parking fee: \$10. Your admission fee includes seasonal attractions such as Butterflies & Blooms, Model Railroad Garden; Landmarks of America, and the Grand Tram Tour. Members always receive free admission and parking.

FREE ADMISSION OPPORTUNITIES The Chicago Botanic Garden extends free general admission in several ways. The Garden offers 52 Free Admission Days for Illinois residents each year. Preregistration for nonmembers is required; parking fees apply.

In addition, the following are admitted free to the Garden during public, daytime hours: active duty U.S. military personnel and/or their families, U.S. military reservists and former POWs, LINK and WIC cardholders and anyone in their households, Illinois educators, and Kids' Museum Passport holders. Parking included; no need to preregister, including on Free Admission Days. chicagobotanic.org/visit

AUTOMATED TELLER MACHINE (ATM) Available in the Visitor Center

LOST & FOUND Available at the Membership & Information Desks in the Visitor Center

EMERGENCIES Call (847) 835-8321. First aid is available at the Membership & Information Desks in the Visitor Center.

HOURS Open daily. For seasonal hours: chicagobotanic.org/visit

PHOTO DISCLAIMER During your visit, you or members of your party may be filmed, videotaped, and/or photographed by a Garden employee, contract photographer, or the media. Your attendance at Garden events serves as permission for the use of your image, or the image of your family members, by the Garden or its designers. Students enrolled in classes at the Joseph Regenstein, Jr. School of the Chicago Botanic Garden may have their artwork, photography, or any other creative work filmed, videotaped, and/or photographed by a Garden employee, contract photographer, or the media. Your enrollment in a Garden class serves as permission for the use of an image of your classwork by the Garden or its designers.

PICNICKING Permitted only in the picnic areas (see map)

ALCOHOL No alcoholic beverages may be brought into the Garden. Any alcohol consumed must be purchased on the premises.

RECYCLING Save this guide or recycle it as you exit the Visitor Center. Aluminum cans, plastic cups, and bottles may be recycled at the Garden View Café or in receptacles throughout the Garden.

INFORMATION Visit the Membership & Information Desks in the Visitor Center or Guest Services on the Welcome Plaza or call (847) 835-5440.

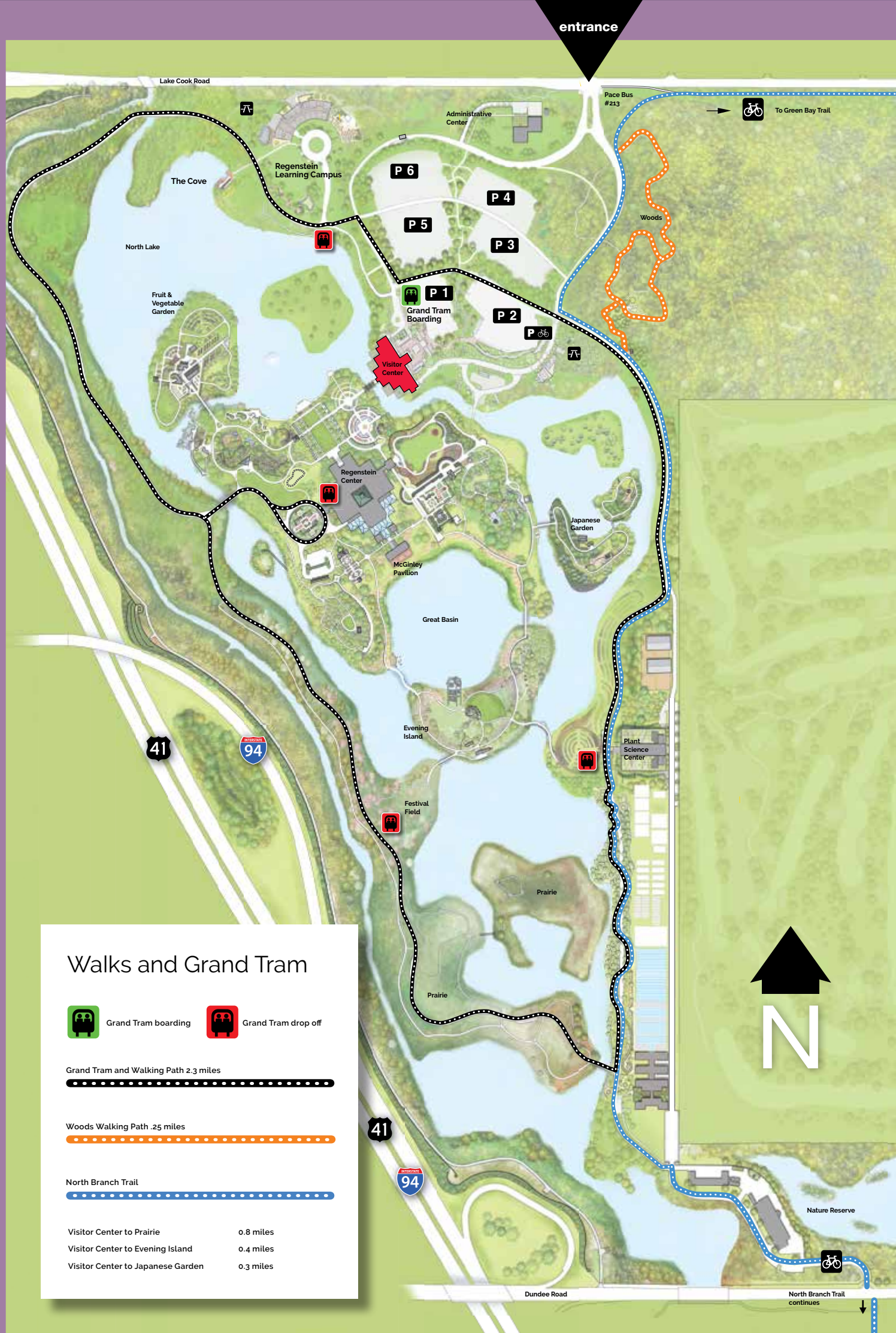

Walks and Grand Tram

Grand Tram boarding Grand Tram drop off

Grand Tram and Walking Path 2.3 miles

Woods Walking Path .25 miles

North Branch Trail

Visitor Center to Prairie 0.8 miles
Visitor Center to Evening Island 0.4 miles
Visitor Center to Japanese Garden 0.3 miles

Garden Guidelines

The Garden is a 385-acre living plant museum. The trees, shrubs, perennials, and annuals are here as exhibits for everyone to enjoy. Please help us protect our plants and grounds.

- Help preserve the Garden's serene atmosphere and maintain its unique and beautiful collection and native habitats. Please refrain from climbing on trees and shrubs; picking fruits and vegetables; walking in garden beds; collecting plants, leaves, flowers, or labels; and feeding wildlife. Refrain from playing on fountains and sculptures.
- The Garden is smoke-free, including e-cigarettes.
- Firearms and other concealed weapons are not allowed on Forest Preserves of Cook County property, except by police officers or active-duty servicemen and servicewomen.
- No pets. Service animals are permitted.
- No drones.
- Keep food out of the gardens and trails. Campfires and outdoor cooking are prohibited.
- To keep the Garden beautiful, if you carry it in, please carry it out. There are limited trash receptacles.
- Bike only on the North Branch Trail. The Forest Preserves of Cook County speed limit for bikes is 8 m.p.h. Park bikes only in designated spaces near the Picnic Glade.
- Active sports and games—including rollerblading, skateboarding, use of scooters and Frisbees (or other gliding objects), ball playing, skiing, swimming, and fishing—are not permitted.

Code of conduct The Chicago Botanic Garden is committed to providing a safe, inclusive, and respectful environment.

Garden staff, volunteers, and all visitors have the right to an environment free from abusive and/or threatening behavior, including use of derogatory or offensive language about another person's race, ethnicity, gender, disability, age, sexual orientation, or national origin. In the event of any such behavior or other conduct that is disrespectful to our staff, volunteers, visitors, or property at any Garden site, we reserve any and all rights permitted by applicable law, including removal, revocation of membership privileges, and prosecution.

The Chicago Botanic Garden also reserves the right to determine what constitutes unacceptable behavior.

chicago botanic garden
PLANTS. PEOPLE. PLANET.

1000 Lake Cook Road, Glencoe, Illinois 60022 U.S.A.
chicagobotanic.org (847) 835-6801

One of the treasures of the Forest Preserves of Cook County

Thank you for your cooperation.



1

2

entrance

3

4

A

A

B

B

C

C

D

D

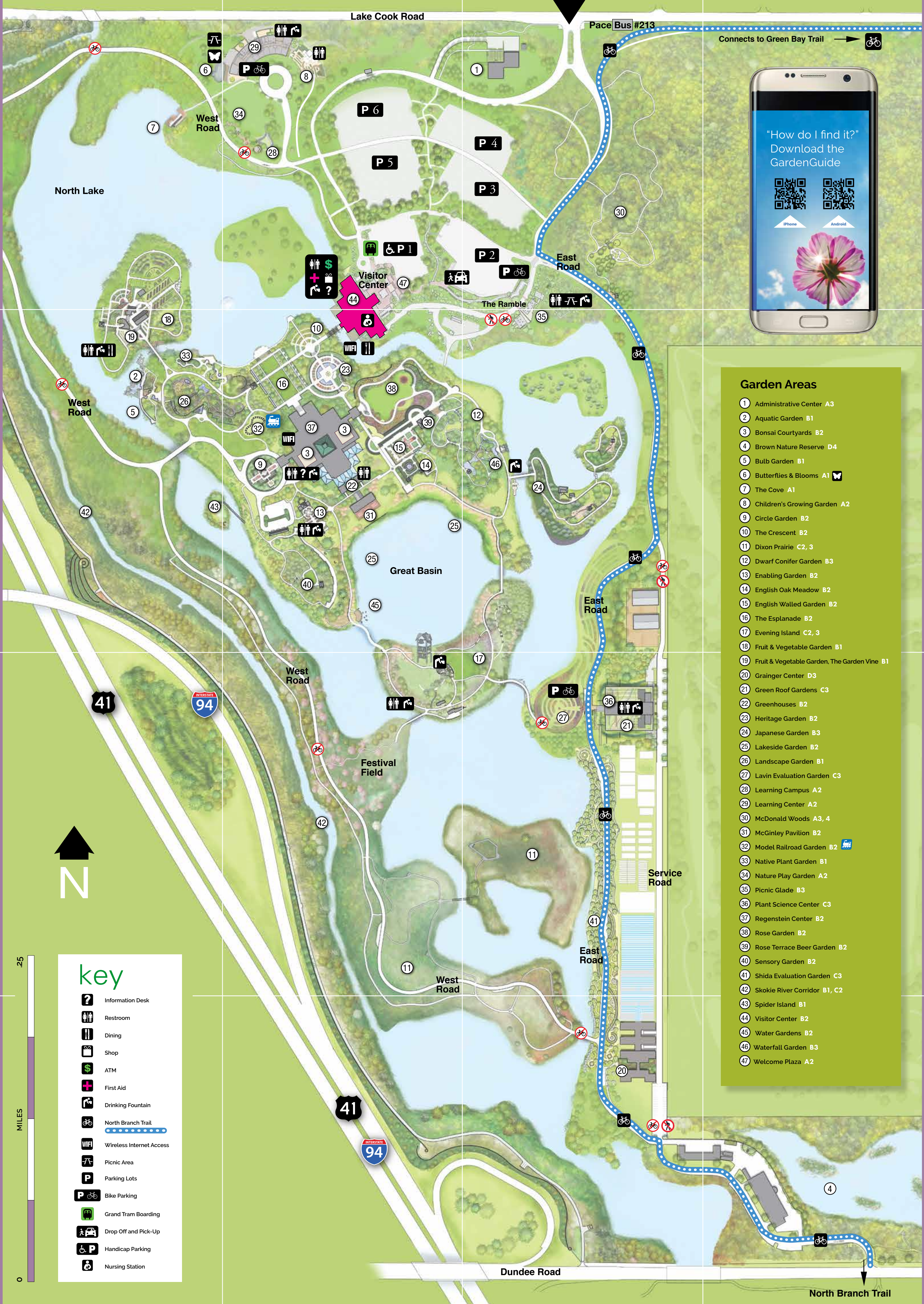

Pace Bus #213
Connects to Green Bay Trail



Garden Areas

- 1 Administrative Center A3
- 2 Aquatic Garden B1
- 3 Bonsai Courtyards B2
- 4 Brown Nature Reserve D4
- 5 Bulb Garden B1
- 6 Butterflies & Blooms A1
- 7 The Cove A1
- 8 Children's Growing Garden A2
- 9 Circle Garden B2
- 10 The Crescent B2
- 11 Dixon Prairie C2, 3
- 12 Dwarf Conifer Garden B3
- 13 Enabling Garden B2
- 14 English Oak Meadow B2
- 15 English Walled Garden B2
- 16 The Esplanade B2
- 17 Evening Island C2, 3
- 18 Fruit & Vegetable Garden B1
- 19 Fruit & Vegetable Garden, The Garden Vine B1
- 20 Grainger Center D3
- 21 Green Roof Gardens C3
- 22 Greenhouses B2
- 23 Heritage Garden B2
- 24 Japanese Garden B3
- 25 Lakeside Garden B2
- 26 Landscape Garden B1
- 27 Lavin Evaluation Garden C3
- 28 Learning Campus A2
- 29 Learning Center A2
- 30 McDonald Woods A3, 4
- 31 McGinley Pavilion B2
- 32 Model Railroad Garden B2
- 33 Native Plant Garden B1
- 34 Nature Play Garden A2
- 35 Picnic Glade B3
- 36 Plant Science Center C3
- 37 Regenstein Center B2
- 38 Rose Garden B2
- 39 Rose Terrace Beer Garden B2
- 40 Sensory Garden B2
- 41 Shida Evaluation Garden C3
- 42 Skokie River Corridor B1, C2
- 43 Spider Island B1
- 44 Visitor Center B2
- 45 Water Gardens B2
- 46 Waterfall Garden B3
- 47 Welcome Plaza A2

key

- Information Desk
- Restroom
- Dining
- Shop
- ATM
- First Aid
- Drinking Fountain
- North Branch Trail
- Wireless Internet Access
- Picnic Area
- Parking Lots
- Bike Parking
- Grand Tram Boarding
- Drop Off and Pick-Up
- Handicap Parking
- Nursing Station

0 .25
MILES



1

2

3

4